

A project by



# VAARAHI *Sky View*



# Typical Floor Plan



Flat No.	1	2
Area in sft.	1320 Sft	1250 Sft
UDS	41	39
Facing	East	West

## Location Highlights

- Layout 40 feet Roads
- GHMC Approved
- Very near to Mainroad



NORTH WIDE ROAD

## Amenities

- HMDA Approved Layout
- Lift Auto closer
- Car Parking
- Childrens Play Area
- EV Charging Point
- CC Cameras
- Bore Water
- Power Backup
- Open Theater With Projector

VAARAHI  
*Sky View*

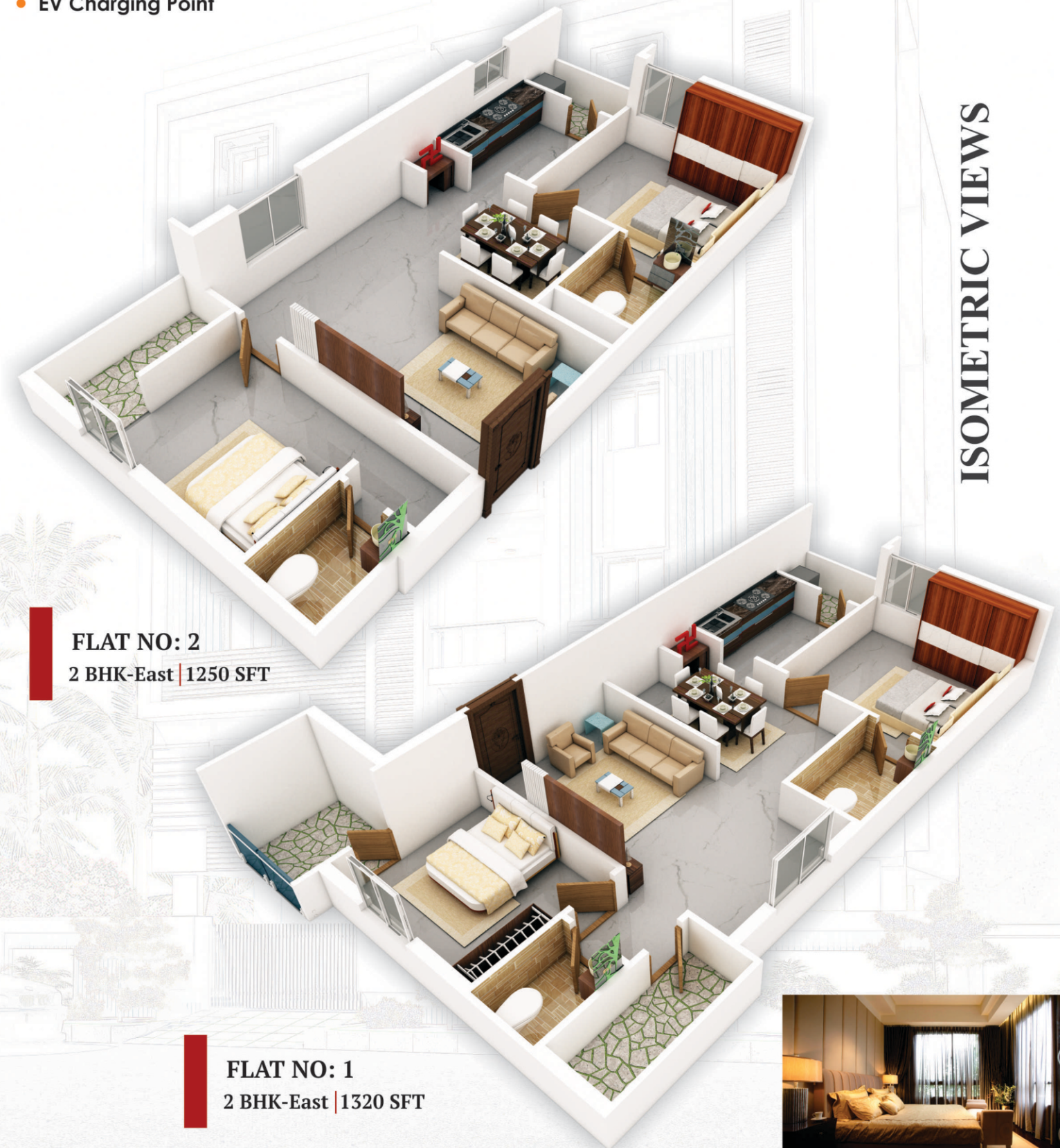

# SPECIFICATIONS



## STRUCTURE :

RCC Framed Structure.



## BRICKS :

Red Bricks Light weight.



## PLASTERING :

Cement with sponge finishing (2 coats).



## MAIN DOOR :

Main Door : Teak wood frame. Veneer Door.  
Other Doors : Other Doors with Teak wood frames & Moulded / Membrane Doors.  
Bathroom : WPC Frames & Doors.



## WINDOWS :

All Windows UPVC with Glass & Grills.



## FLOORING :

4'X2' Vitrified tiles flooring for hall, bedrooms, dining, kitchen and balcony.



## KITCHEN :

Granite platform with stainless steel sink.  
Tilles - Up to 2 feet height.



## PAINTING :

Two coats of Asian Paints-Premium over Birla / Standard wall care putty on in side Walls two coats, Asian paints Apex for outside walls.



## ELECTRICAL :

Havells copper wire and Switches Anchor Penta.



## TOILETS :

Anti-skid flooring, Digital Tiles walls.



## PLUMBING & SANITARY :

Good Quality PVC & CPVC (Hindware), pipes (water & shower pipes).

Good Quality material, taps, wall mixer & shower (Hindware/Cera).

Model: 2 Bhk One western Commodes & one Indian Commode (Hindware/Cera).  
One wash Basin (Hindware/Cera).

## RAILING :

Railing made with S.S Steel.



## GENERATOR :

100% DG back-up for common area.



## LIFT :

Lift Auto closer.



## NOTE :

Registration, GST & Amenities charges borne by Customer.

Any modifications Charges applicable.

# Car Parking Plan



Promoters & Developers



**VAARAHI**  
**PROJECTS**

Cell No: +91 93908 90713  
+91 79959 92297

Site Address :

**VAARAHI**  
*Sky View*

PNR Colony Road No: 20, Ameenpur,  
Hyderabad.

Note: This brochure is a conceptual presentation and not a legal offering. The promoter reserve the right make changes in plans, specifications and elevation as deemed fit.

designed by Barma Ad Systems +91 98664 01362 +91 8897384503 23/04/26